

Vantron VT-SBCQ7-MX8X is a high-performance and low-power processor board design for industrial applications. Connector with Gold Finger.

This product is based on Freescale ARM Cortex-A35 iMX8X quad core processor. On board 3GB DDR4 and 16GB EMMC. Support wide temperature -40° C to +80° C.

Support Linux OS. Support Software Development Kits (SDK).



Specifications

Standard	Connector	Qseven standard processor board. Connect with Gold Finger	
System	Processor	iMX8XQ Quad ARM Cortex-A35 1.2GHz+Cortex-M4 266MHz	
	RAM	On board 3GB LPDDR4	
	Storage	On board 16GB EMMC (Up to 64GB)	
	Ext Storage	1 x micro-SD	
Display	Video Out	2xMIPI/LVDS up to 1920x1080 Display	
	Touch Screen	I2C, USB support	
Camera	CSI	1xMIPI CSI. Support 1ch 1080P input.	
I/O Ports	Ethernet	10M/100M/1000Mbps, Ethernet PHY is AR8035.	
	USB	4xUSB2.0 , 1xUSB2.0 OTG	
	Audio	Support 1xI2S audio digital interface	
	UART	4xUART, 1xUART for Debug	
	PCIe	1xPCIE 1Line	
	SPI	1xSPI, 2xCS	
	QSPI	2xQSPI	
	RTC	Support by RTC chip	
	Watch Dog	Support by External watchdog chip TPL5010	
	SDIO	1xSDIO 3.0	
	CAN	2xCAN/CAN-FD	
	I2C	4xI2C Bus	
	GPIO	8xGPIOs, 3.3V.	
	Software	OS	Support Linux OS
		SDK	Support
	Power	Input	5V/1A(standard)
Mechanical	Dimensions	70mm x 70mm	
Environment Condition	Temperature	Operating:-20°C ~ +70°C (Optional Wide Temperature:-40°C ~ +80°C) Storage: -40°C ~ +85°C	

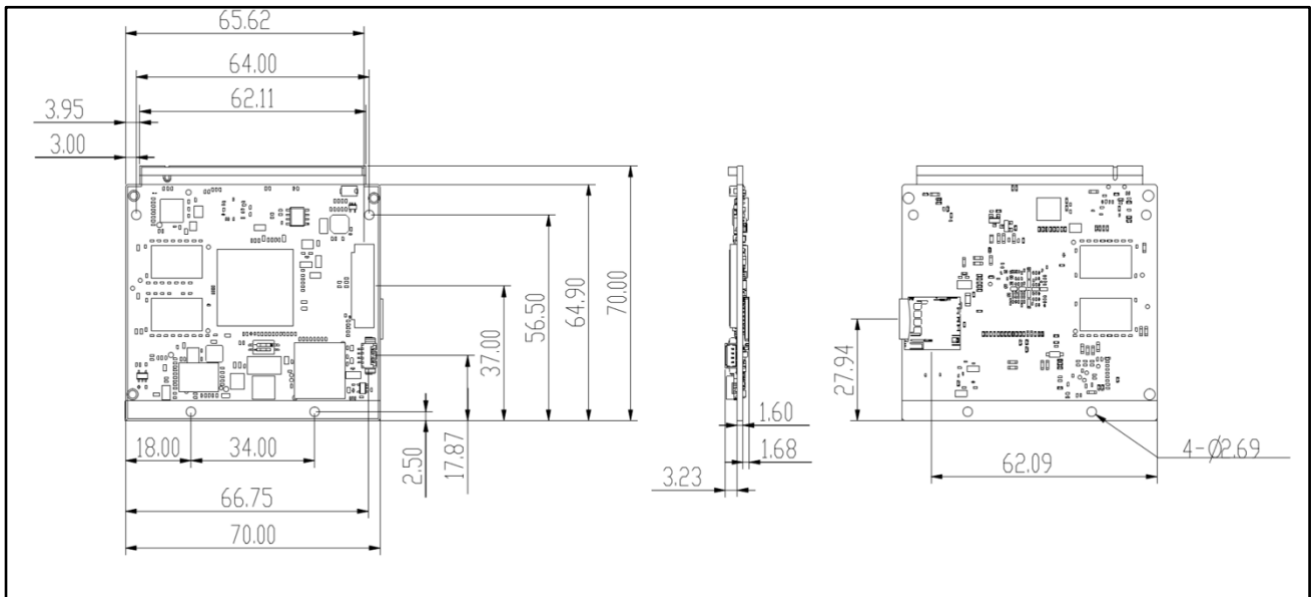

Accessory

Mounting Screw	4pc
Mounting Nut	4pc

Order Information

VT-SBCQ7-MX8X	-XX	X
	16:16G	C: -20° C ~ +70° C
	32:32G	I: -40° C ~ +80° C
	64:64G	
	Or Other	
Sample	VT-SBCQ7-MX6X-16I	
<p>Notes: All specifications are subject to change without notice. Please contact Vantron for additional requirements.</p>		